

New Unit To Be Developed

Unit B Boldon Leisure Park, Newcastle upon Tyne, NE35 9PB



KEY INFORMATION

- ✓ Occupiers include 11 screen Cineworld, Starbucks, McDonalds, Nando's, Tim Hortons and Gourmet 4
- ✓ 472 free parking spaces
- ✓ Adjacent to 135,000 sqft Asda Superstore
- ✓ Mixed residential/commercial area
- ✓ Half a mile from the A19



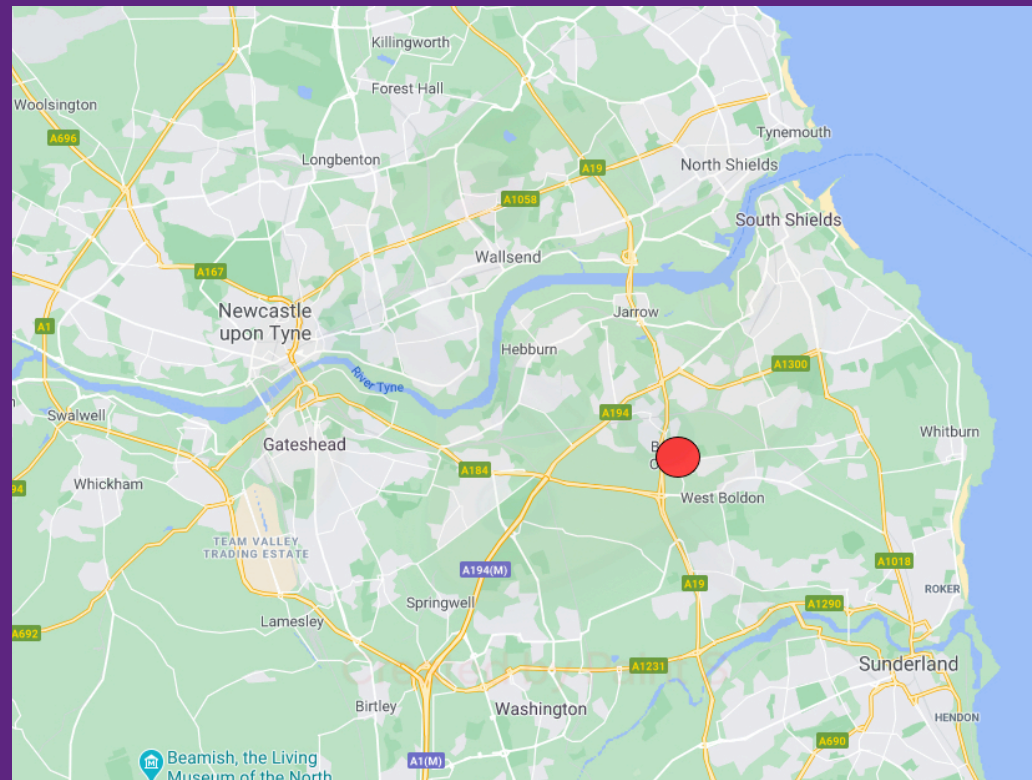
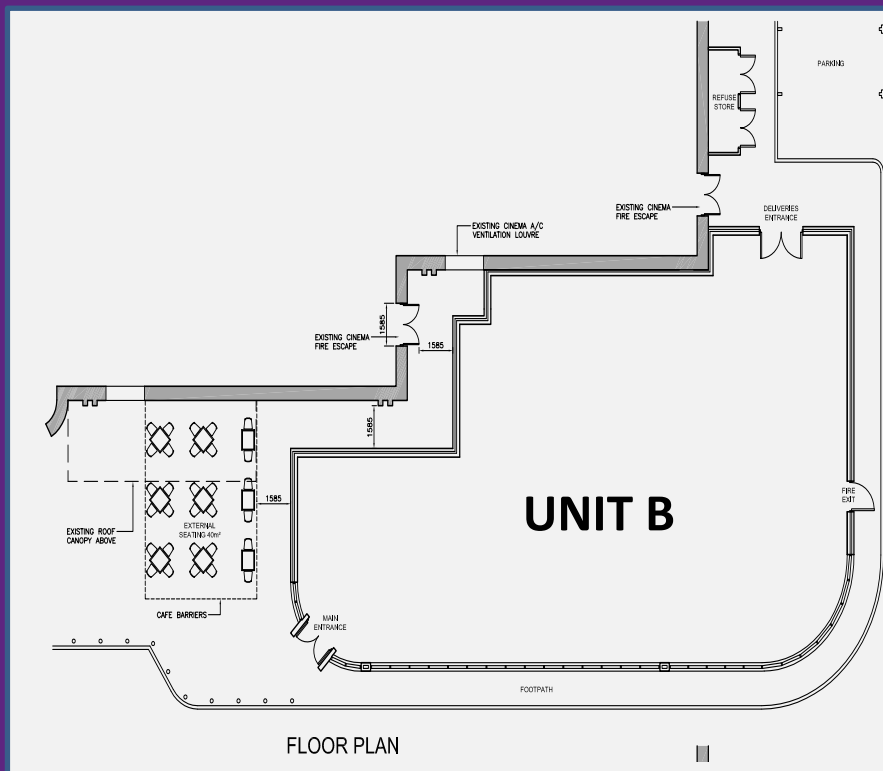

UNIT INFORMATION

Rent: On application

Service charge: c. £3 psf

Rateable Value: to be assessed

GIA: 3,436 sq ft (may divide)
Ground floor with
scope for mezzanine

EPC: N/A

Terms: Minimum 10
years required



RICHARD SHUTTLEWORTH
07747 008458
rs@pudneyshuttleworth.co.uk

WILL HEPPLEWHITE
07846 006790
wh@pudneyshuttleworth.co.uk

TOM HODGSON
07850 421525
th@pudneyshuttleworth.co.uk



